



CareMat A

The pressure-sensitive mat for supervision of people with dementia and disorientation

Product Description

CareMat is used in retirement and nursing homes as well as in hospitals and similar facilities. It is placed beside the patient's bed and connected to the in-house nurse call system. As soon as the person leaves the bed and steps onto the CareMat, a signal is triggered via the nurse call system. This allows the personnel on duty to establish at any time of the day or night, when and where a patient got out of bed. As a result, CareMat contributes to providing assistance immediately, thus significantly reducing the risk of falls or the danger of patient wandering.



Selection chart

	CareMat	A	0	1	T	E868
■ Dimension code						
A		1100 x 700 mm				
B		700 x 400 mm				
C		1100 x 700 mm, semi-circular				
M		283 x 202 mm, sample				
■ Colour code						
0		Careyellow				
1		Caregrey				
■ Case code						
1		56 x 38 x 9.6 mm				
5		Ekahau A4 WiFi Tag				
■ Type code						
E		Empty				
C		Open cable head				
P		PCB, additional functions				
T		Transmitter				
■ Transmitter type code						
B434		TeleAlarm 434.01 MHz				
E868		ELDAT 868.30 MHz				
L433		Lehmann electronic 433.92 MHz				
L869		Lehmann electronic 869.2125 MHz				
L869.23		Lehmann electronic 869.2375 MHz				
EK2.4		Ekahau 2.4 GHz				

Features

- Dimensions 1100 x 700 mm
- Hard-wired and wireless versions
- A robust and reliable alarm sensor
- Hygienic: Easy to clean and resistant to bodily fluids

Content

- 1 Product description
Selection chart
Features
- 2 Model list
Technical specifications
- 3 Technical specifications
CareMat dimensions
- 4 Technical specifications
Case dimensions
- 5 Product details

Model list

Product		Colour	Part number	Description
CareMat	A01E	Careyellow	303413	1100 x 700 mm / empty housing
	A11E	Caregrey	357800	
CareMat	A01C	Careyellow	303410	1100 x 700 mm / cable
	A11C	Caregrey	357789	
CareMat	A01P	Careyellow	307485	1100 x 700 mm / universal PCB with cable
	A11P	Caregrey	357803	
CareMat	A01T B434	Careyellow	303415	1100 x 700 mm / TeleAlarm radio transmitter 434.01 MHz
	A11T B434	Caregrey	357801	
CareMat	A01T E868	Careyellow	303416	1100 x 700 mm / ELDAT radio transmitter 868.30 MHz
	A11T E868	Caregrey	357802	
CareMat	A01T L433	Careyellow	336635	1100 x 700 mm / Lehmann radio transmitter 433.92 MHz
	A11T L433	Caregrey	357805	
CareMat	A01T L869	Careyellow	336670	1100 x 700 mm / Lehmann radio transmitter 869.2125 MHz
	A11T L869	Caregrey	357806	
CareMat	A01T L869.23	Careyellow	356638	1100 x 700 mm / Lehmann radio transmitter 869.2375 MHz
	A11T L869.23	Caregrey	357807	
CareMat	A05T EK2.4	Careyellow	338759	1100 x 700 mm / Ekahau A4 WiFi Tag 2.4 GHz
	A15T EK2.4	Caregrey	357808	

Technical Specifications

Characteristics

■ CareMat General

Dimensions	1100 x 700 x x 9.5 mm / height standard case 1: 14.5 mm, height Ekahau WiFi case 5: 20 mm
Weight	8.2 kg
Material	Polyurethane PU
Colour	Careyellow / Caregrey
Surface	Nub structure with sloped edges
Person activation weight	Min. 10 kg
Chemical resistance	Water, bodily fluids, commercially available disinfectants, max. 70 % vol. alcohol
Protection class	IP54, dust- and splash-proof
Temperature range	0 to +55 °C

■ CareMat versions with cable

CareMat A01E / A11E

Connection	This CareMat can be equipped by cable or various transmitters.
EC-Conformity	RoHS 2011/65/EU

CareMat A01C / A11C

Cable	Length 3 m, diameter 5.2 ± 0.2 mm, cable colour white
Cable type	4-wire, LiYYv 4 x 0.34 mm ² , wire colours BN/YE/GN/WH, open cable head
Cable as spare part	According to above specifications available, part number 307131
Signal output	Normally open contact (NO)
Admissible capacity	Max. 50 mA at 48 V AC/DC
EC-Conformity	RoHS 2011/65/EU, GPS 2001/95/EC

Characteristics

CareMat A01P / A11P

Cable	Length 3 m, diameter 5.2 ± 0.2 mm, cable colour white
Cable type	4-wire, LiYYv 4 x 0.34 mm², wire colours BN/YE/GN/WH, open cable head
Cable as spare part	According to above specifications available, part number 307131
Signal output	Normally open contact (NO) or resistance monitoring (acc. to VDE 0834)
Operating voltage	3-24 VDC
Operating current	Max. 25 mA
EC-Conformity	RoHS 2011/65/EU, EMC 2014/30/EU
Functionalities universal PCB	The CareMat A01P / A11P (P = circuit board) includes a universal circuit board in the housing. The universal circuit board can be adapted to your needs by altering the switch positions. The wiring on the universal circuit board must not be removed. The connections are protected against wrong polarity of input voltage.

Variable resistance R

The universal circuit board has two connector sockets for commercially-available wired resistors. A call resistor that is specifically for the call system for line monitoring can be installed in this. The connecting wiring should have a diameter between 0.38 and 0.56 mm. The socket spacing should be 14 mm.

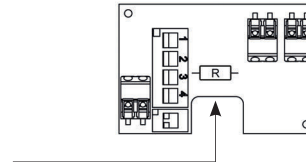

NC contact

The NC (normally closed) contact option, which can be selected on the universal PCB, is a transistor circuit. It operates according to the quiescent current principle. If the CareMat is not actuated, a quiescent current flows through the NC contact as a result of the externally applied voltage. If the resident / patient actuates the CareMat by stepping on it, this NC contact is opened. This can be detected by a nurse call system operating according to the quiescent current principle that monitors the current flow.

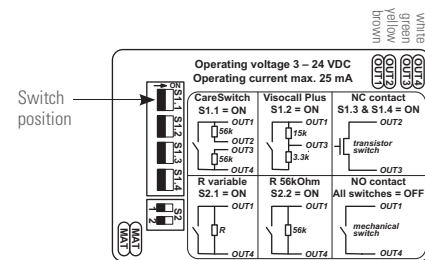

CareMat wireless versions

CareMat A01T B434 / A11T B434

Radio transmitter	TeleAlarm, 1 channel, unidirectional
Radio frequency	434.01 MHz, TeleAlarm protocol
Radio range	up to 30 m in buildings, dependent on structural building conditions (up to 250 m in free field)
Battery type	1 x CR2032, 3V Lithium button cell
Battery lifetime	3 years (at 3 alarms and 1 daily test transmission)
EC-Conformity	RoHS 2011/65/EU, RED 2014/53/EU

CareMat A01T E868 / A11T E868

Radio transmitter	ELDAT, 1 channel, unidirectional
Radio frequency	868.30 MHz, EasyWave® protocol
Radio range	up to 30 m in buildings, dependent on structural building conditions (up to 250 m in free field)
Battery type	1 x CR2032, 3V Lithium button cell
Battery lifetime	2 years
EC-Conformity	RoHS 2011/65/EU, RED 2014/53/EU

CareMat A01T L433 / A11T L433

Radio transmitter	Lehmann electronic VarioRec®, 1 channel, unidirectional
Radio frequency	433.92 MHz, VarioRec® protocol
Radio range	up to 30 m in buildings, dependent on structural building conditions (up to 100 m in free field)
Battery type	1 x CR2032, 3V Lithium button cell
Battery lifetime	3 years
Battery monitoring	Battery low message
EC-Conformity	RoHS 2011/65/EU, RED 2014/53/EU

Characteristics

CareMat A01T L869 / A11T L869

Radio transmitter	Lehmann electronic VarioRec®, 1 channel, unidirectional
Radio frequency	869.2125 MHz, VarioRec® protocol
Radio range	up to 30 m in buildings, dependent on structural building conditions (up to 100 m in free field)
Battery type	1 x CR2032, 3V Lithium button cell
Battery lifetime	3 years
Battery monitoring	Battery low message
EC-Conformity	RoHS 2011/65/EU, RED 2014/53/EU

CareMat A01T L869.23 / A11T L869.23

Radio transmitter	Lehmann electronic VarioRec®, 1 channel, unidirectional
Radio frequency	869.2375 MHz, VarioRec® protocol
Radio range	up to 30 m in buildings, dependent on structural building conditions (up to 100 m in free field)
Battery type	1 x CR2032, 3V Lithium button cell
Battery lifetime	3 years
Battery monitoring	Battery low message
EC-Conformity	RoHS 2011/65/EU, RED 2014/53/EU

CareMat A05T EK2.4 / A15T EK2.4

Radio transmitter	Ekahau A4 WiFi Tag
Radio frequency	802.11b/g 2.4GHz Wi-Fi networks
Radio range	up to 40 m @ 11Mbit/s in buildings, dependent on structural building conditions (up to 60 m @ 2Mbit/s in free field)
Battery type	2 x CR2, 3V Lithium round cell
Battery lifetime	18 months (in 24h by 4 interval alive events / 2 CareMat movement events / 3 person step on events)
Battery monitoring	Battery low message
EC-Conformity	RoHS 2011/65/EU, RED 2014/53/EU

CareMat Dimensions

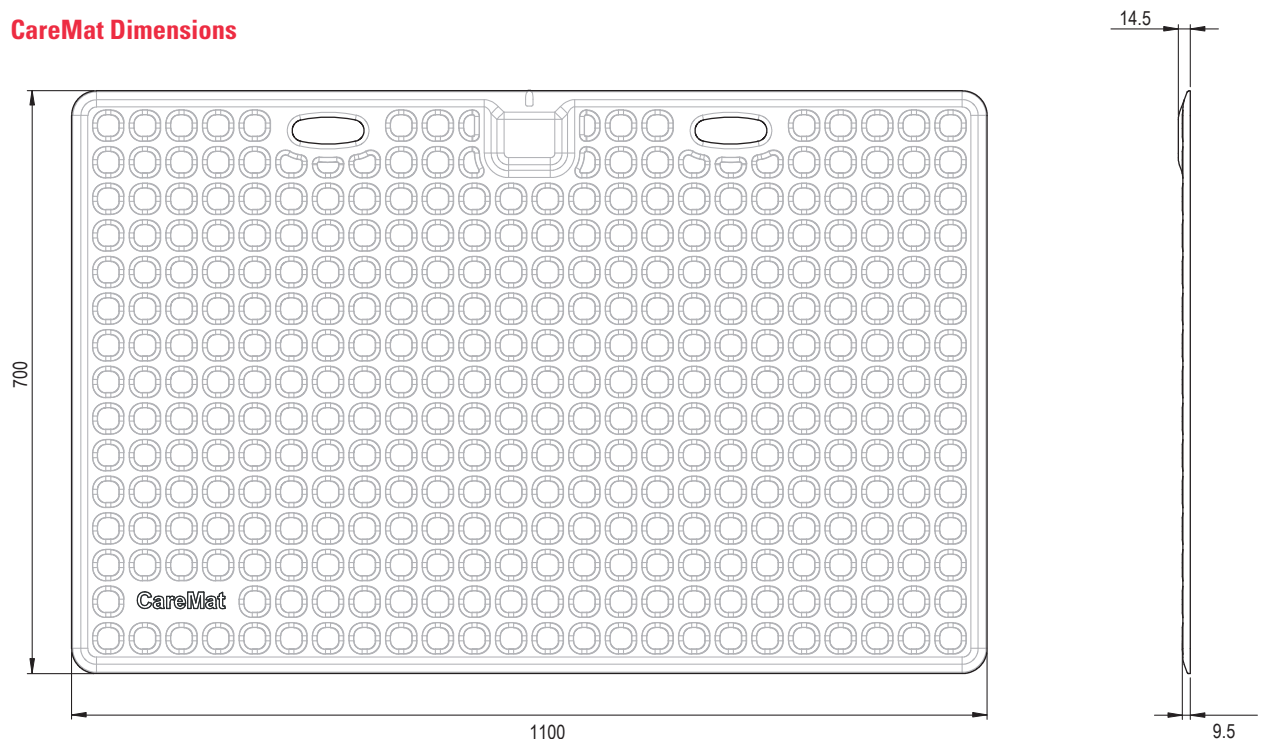

1 Case Dimensions (Standard)

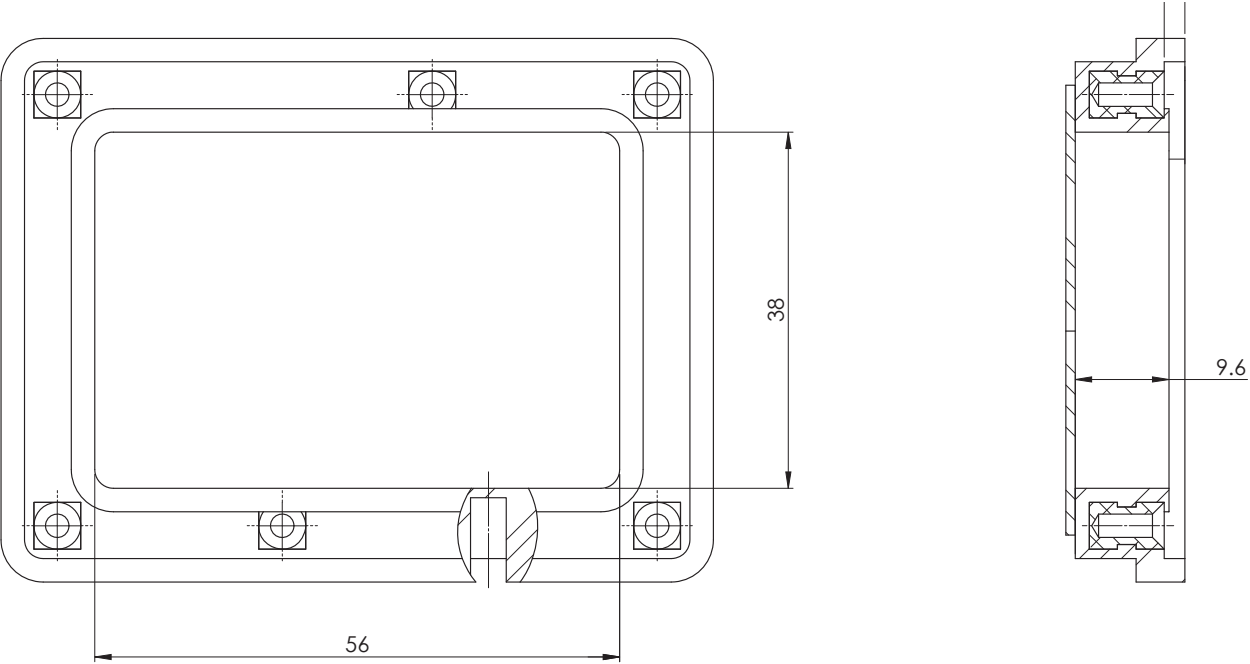

5 Case Dimensions (Ekahau)

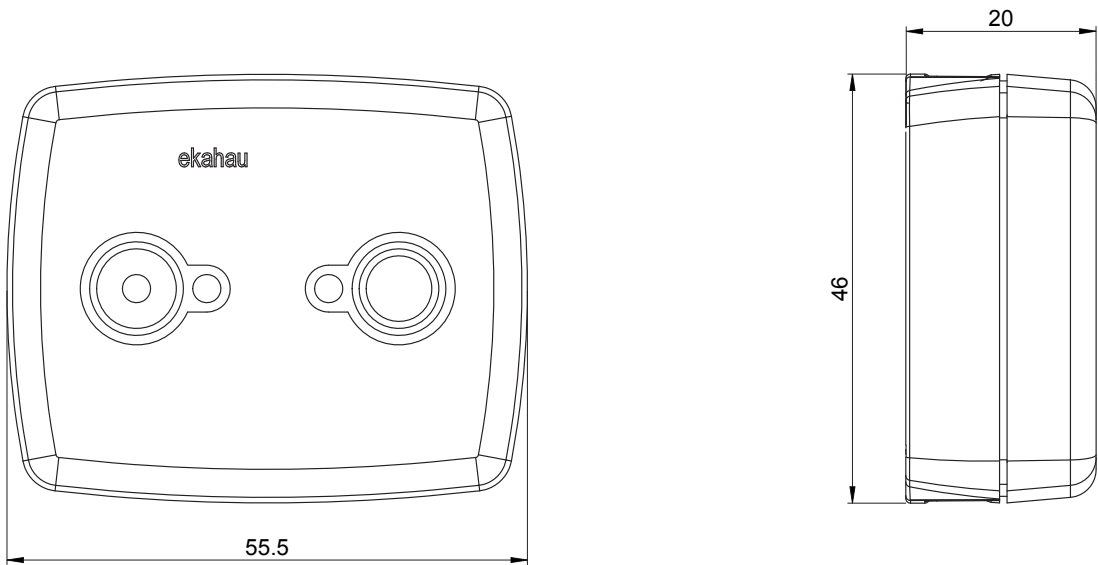

Product Details

Front

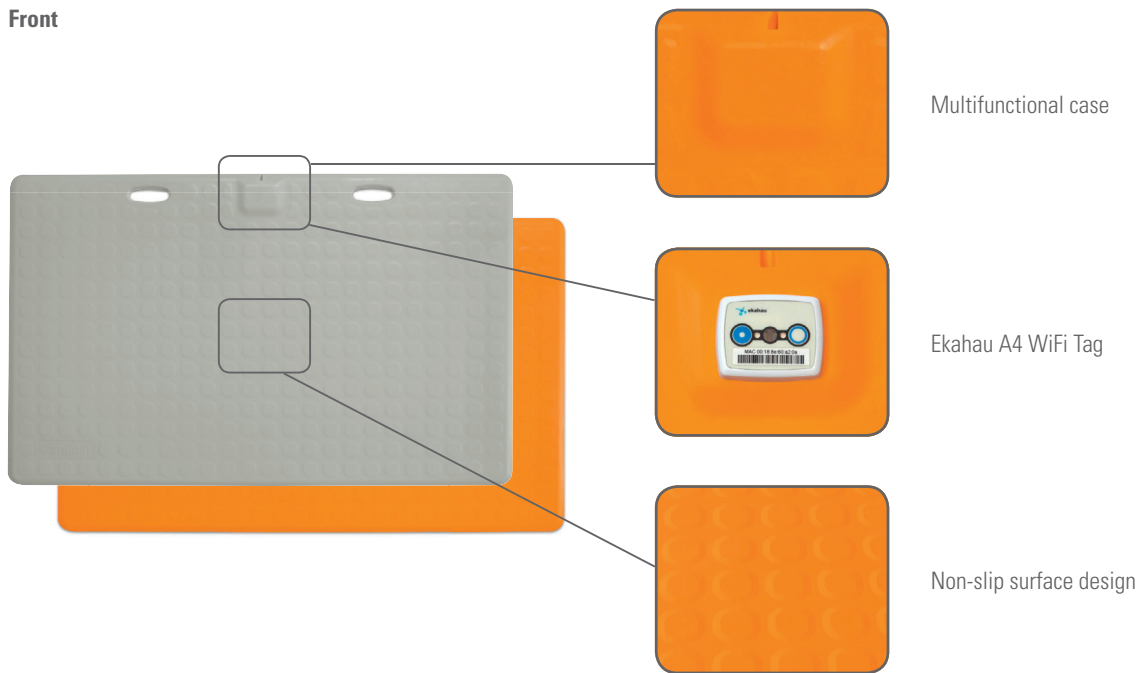

Back

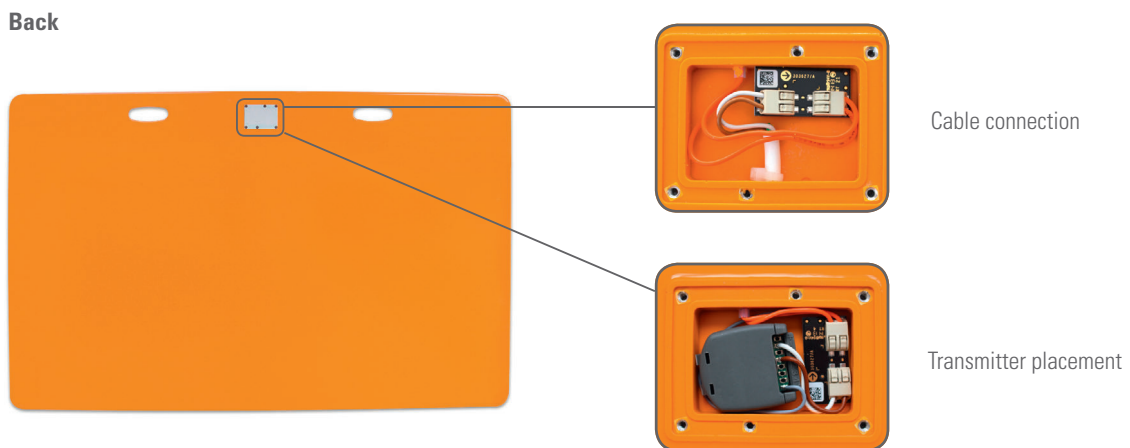

Packaging



For more information contact



1300 871 322
micromaxhealth.com
info@micromaxhealth.com

